

**Ozubené tyče, ozubené
kolesá kužeľové súkolia**

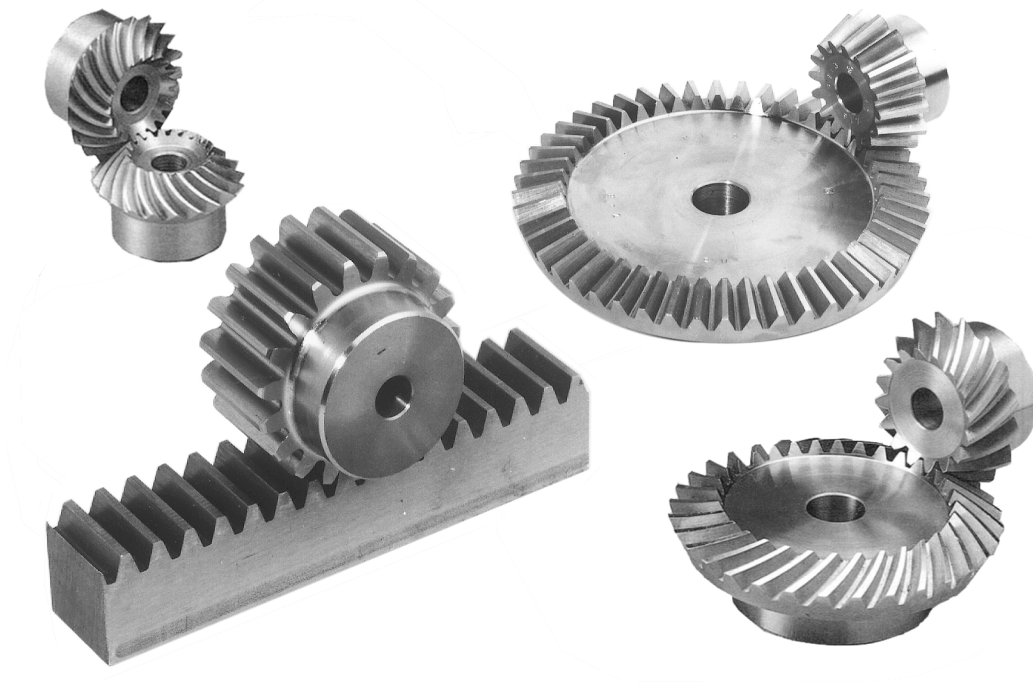

INFO O VÝROBKU

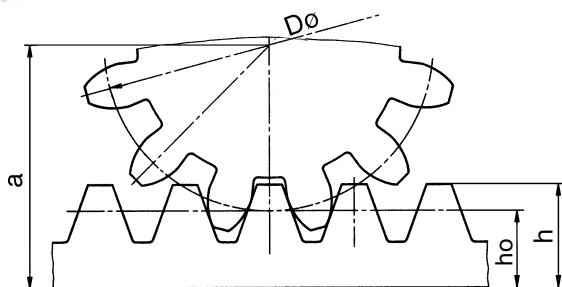

a = vzdialenos osy
 $D\varnothing$ = rozte ný priemer
 ho = vzdialenos rozte nej osy

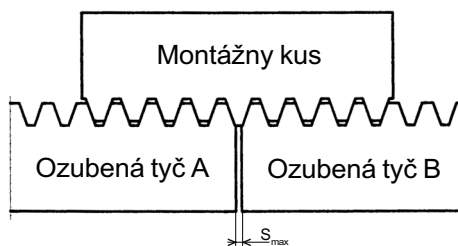

| | | | | | | | |
|-----------|-----|-----|-----|-----|-----|-----|-----|
| Modul | 1.0 | 1.5 | 2.0 | 2.5 | 3.0 | 4.0 | 5.0 |
| S_{max} | 1.0 | 1.2 | 1.5 | 2.0 | 2.2 | 3.0 | 3.6 |

Mierka 1:1

Modul

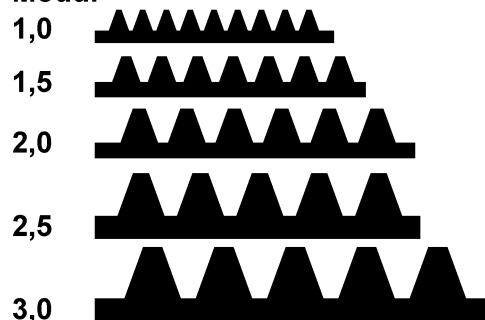

Modul

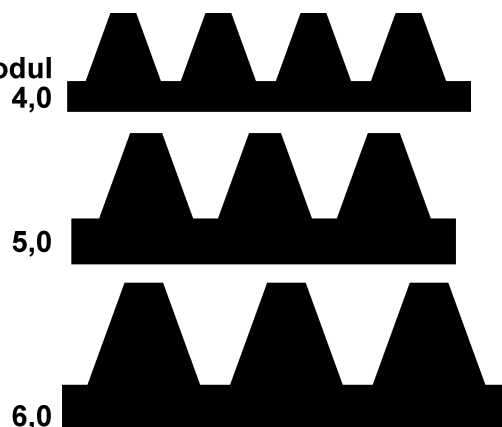

Ozubená tyč

Uhol záberu 20°

Oce C 43

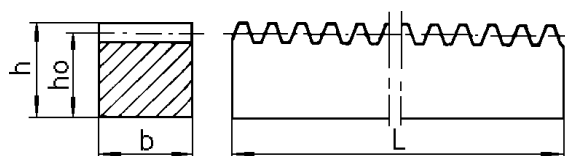
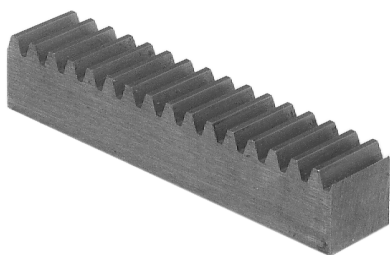

D žka = 1000 mm
 Obj. číslo

D žka = 2000 mm
 Obj. číslo

| | |
|---------|---------|
| T 78923 | T 17063 |
| T 78924 | T 17064 |
| T 78925 | T 17065 |
| T 78926 | T 17066 |
| T 78927 | T 17067 |
| T 79405 | T 31701 |
| T 78928 | T 17068 |
| T 78929 | T 17069 |
| T 78930 | T 17070 |

| Modul | b(h11) | h(h14) | ho | kg/m |
|-------|--------|--------|------|--------|
| 1 | 15 | 15 | 14.0 | 3.050 |
| 1.5 | 17 | 17 | 15.5 | 3.830 |
| 2 | 20 | 20 | 18.0 | 5.115 |
| 2.5 | 25 | 25 | 22.5 | 7.350 |
| 3 | 30 | 30 | 27.0 | 11.470 |
| 4 | 30 | 30 | 26.0 | 11.700 |
| 4 | 40 | 40 | 36.0 | 20.350 |
| 5 | 50 | 50 | 45.0 | 29.415 |
| 6 | 60 | 60 | 54.0 | 50.200 |

Ozubené koleso

Priame ozubenie, uhol záberu 20°

Oce C 43

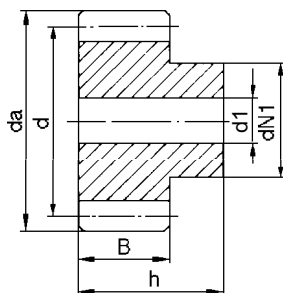

| | B | h |
|-----------|----|----|
| Modul 1 | 15 | 25 |
| Modul 1.5 | 17 | 30 |

Modul 1

| Obj. číslo | zubov | da | d | dN1 | d1 | Obj. číslo | zubov | da | d | dN1 | d1 |
|------------|-------|----|----|-----|----|------------|-------|----|----|-----|----|
| T 16837 | 12 | 14 | 12 | 9 | - | T 43361 | 42 | 44 | 42 | 30 | 10 |
| T 16838 | 13 | 15 | 13 | 10 | - | T 43362 | 43 | 45 | 43 | 30 | 10 |
| T 16839 | 14 | 16 | 14 | 11 | - | T 43363 | 44 | 46 | 44 | 30 | 10 |
| T 16840 | 15 | 17 | 15 | 12 | 6 | T 16856 | 45 | 47 | 45 | 30 | 10 |
| T 16841 | 16 | 18 | 16 | 13 | 6 | T 43364 | 46 | 48 | 46 | 30 | 10 |
| T 16842 | 17 | 19 | 17 | 14 | 8 | T 43365 | 47 | 49 | 47 | 30 | 10 |
| T 16843 | 18 | 20 | 18 | 15 | 8 | T 16857 | 48 | 50 | 48 | 30 | 10 |
| T 16844 | 19 | 21 | 19 | 15 | 8 | T 43366 | 49 | 51 | 49 | 30 | 10 |
| T 16845 | 20 | 22 | 20 | 16 | 8 | T 16858 | 50 | 52 | 50 | 30 | 12 |
| T 16846 | 21 | 23 | 21 | 16 | 8 | T 43367 | 51 | 53 | 51 | 40 | 12 |
| T 16847 | 22 | 24 | 22 | 16 | 8 | T 16859 | 52 | 54 | 52 | 40 | 12 |
| T 16848 | 23 | 25 | 23 | 18 | 8 | T 43368 | 53 | 55 | 53 | 40 | 12 |
| T 16849 | 24 | 26 | 24 | 20 | 10 | T 43369 | 54 | 56 | 54 | 40 | 12 |
| T 16850 | 25 | 27 | 25 | 20 | 10 | T 43370 | 55 | 57 | 55 | 40 | 12 |
| T 43350 | 26 | 28 | 26 | 20 | 10 | T 16860 | 56 | 58 | 56 | 40 | 12 |
| T 43351 | 27 | 29 | 27 | 20 | 10 | T 43371 | 57 | 59 | 57 | 40 | 12 |
| T 16851 | 28 | 30 | 28 | 20 | 10 | T 43372 | 58 | 60 | 58 | 40 | 12 |
| T 43352 | 29 | 31 | 29 | 20 | 10 | T 43373 | 59 | 61 | 59 | 40 | 12 |
| T 16852 | 30 | 32 | 30 | 20 | 10 | T 16861 | 60 | 62 | 60 | 40 | 12 |
| T 43353 | 31 | 33 | 31 | 25 | 10 | T 43374 | 61 | 63 | 61 | 50 | 12 |
| T 43354 | 32 | 34 | 32 | 25 | 10 | T 43375 | 62 | 64 | 62 | 50 | 12 |
| T 43355 | 33 | 35 | 33 | 25 | 10 | T 43376 | 63 | 65 | 63 | 50 | 12 |
| T 43356 | 34 | 36 | 34 | 25 | 10 | T 43377 | 64 | 66 | 64 | 50 | 12 |
| T 43357 | 35 | 37 | 35 | 25 | 10 | T 43378 | 65 | 67 | 65 | 50 | 12 |
| T 16853 | 36 | 38 | 36 | 25 | 10 | T 43379 | 66 | 68 | 66 | 50 | 12 |
| T 43358 | 37 | 39 | 37 | 25 | 10 | T 43380 | 67 | 69 | 67 | 50 | 12 |
| T 16854 | 38 | 40 | 38 | 25 | 10 | T 43381 | 68 | 70 | 68 | 50 | 12 |
| T 43359 | 39 | 41 | 39 | 25 | 10 | T 43382 | 69 | 71 | 69 | 50 | 12 |
| T 16855 | 40 | 42 | 40 | 25 | 10 | T 43383 | 70 | 72 | 70 | 50 | 12 |
| T 43360 | 41 | 43 | 41 | 30 | 10 | | | | | | |

Modul 1.5

| | | | | | | | | | | | |
|---------|----|------|------|----|----|---------|----|------|------|----|----|
| T 16862 | 12 | 21.0 | 18.0 | 14 | 8 | T 16873 | 23 | 37.5 | 34.5 | 25 | 10 |
| T 16863 | 13 | 22.5 | 19.5 | 15 | 8 | T 16874 | 24 | 39.0 | 36.0 | 25 | 10 |
| T 16864 | 14 | 24.0 | 21.0 | 17 | 8 | T 16875 | 25 | 40.5 | 37.5 | 25 | 10 |
| T 16865 | 15 | 25.5 | 22.5 | 18 | 8 | T 43385 | 26 | 42.0 | 39.0 | 30 | 12 |
| T 16866 | 16 | 27.0 | 24.0 | 19 | 8 | T 43386 | 27 | 43.5 | 40.5 | 30 | 12 |
| T 16867 | 17 | 28.5 | 25.5 | 20 | 8 | T 16876 | 28 | 45.0 | 42.0 | 30 | 12 |
| T 16868 | 18 | 30.0 | 27.0 | 20 | 8 | T 43387 | 29 | 46.5 | 43.5 | 30 | 12 |
| T 16869 | 19 | 31.5 | 28.5 | 20 | 8 | T 16877 | 30 | 48.0 | 45.0 | 30 | 12 |
| T 16870 | 20 | 33.0 | 30.0 | 25 | 8 | T 43388 | 31 | 49.5 | 46.5 | 35 | 12 |
| T 16871 | 21 | 34.5 | 31.5 | 25 | 10 | T 43389 | 32 | 51.0 | 48.0 | 35 | 12 |
| T 16872 | 22 | 36.0 | 33.0 | 25 | 10 | T 43390 | 33 | 52.5 | 49.5 | 35 | 12 |

Ozubené koleso

Priame ozubenie, uhol záberu 20°

Oce C 43

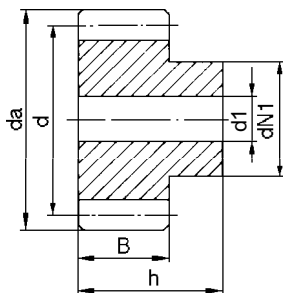

| | B | h |
|-----------|----|----|
| Modul 1.5 | 17 | 30 |
| Modul 2 | 20 | 35 |

Modul 1.5

| Obj. číslo | zubov | da | d | dN1 | d1 | Obj. číslo | zubov | da | d | dN1 | d1 |
|------------|-------|------|------|-----|----|------------|-------|-------|-------|-----|----|
| T 43391 | 34 | 54.0 | 51.0 | 35 | 12 | T 43403 | 53 | 82.5 | 79.5 | 60 | 14 |
| T 43392 | 35 | 55.5 | 52.5 | 35 | 12 | T 43404 | 54 | 84.0 | 81.0 | 60 | 14 |
| T 16878 | 36 | 57.0 | 54.0 | 35 | 12 | T 43405 | 55 | 85.5 | 82.5 | 60 | 14 |
| T 43393 | 37 | 58.5 | 55.5 | 40 | 12 | T 16885 | 56 | 87.0 | 84.0 | 60 | 16 |
| T 16879 | 38 | 60.0 | 57.0 | 40 | 12 | T 43406 | 57 | 88.5 | 85.5 | 60 | 16 |
| T 43394 | 39 | 61.5 | 58.5 | 40 | 12 | T 43407 | 58 | 90.0 | 87.0 | 60 | 16 |
| T 16880 | 40 | 63.0 | 60.0 | 40 | 12 | T 43408 | 59 | 91.5 | 88.5 | 60 | 16 |
| T 43395 | 41 | 64.5 | 61.5 | 40 | 12 | T 16886 | 60 | 93.0 | 90.0 | 60 | 16 |
| T 43396 | 42 | 66.0 | 63.0 | 50 | 12 | T 43409 | 61 | 94.5 | 91.5 | 70 | 16 |
| T 43397 | 43 | 67.5 | 64.5 | 50 | 12 | T 43411 | 62 | 96.0 | 93.0 | 70 | 16 |
| T 43398 | 44 | 69.0 | 66.0 | 50 | 12 | T 43412 | 63 | 97.5 | 94.5 | 70 | 16 |
| T 16881 | 45 | 70.5 | 67.5 | 50 | 12 | T 43413 | 64 | 99.0 | 96.0 | 70 | 16 |
| T 43399 | 46 | 72.0 | 69.0 | 50 | 14 | T 43414 | 65 | 100.5 | 97.5 | 70 | 16 |
| T 43400 | 47 | 73.5 | 70.5 | 50 | 14 | T 43415 | 66 | 102.0 | 99.0 | 70 | 16 |
| T 16882 | 48 | 75.0 | 72.0 | 50 | 14 | T 43416 | 67 | 103.5 | 100.5 | 70 | 16 |
| T 43401 | 49 | 76.5 | 73.5 | 50 | 14 | T 43417 | 68 | 105.0 | 102.0 | 70 | 16 |
| T 16883 | 50 | 78.0 | 75.0 | 50 | 14 | T 43418 | 69 | 106.5 | 103.5 | 70 | 16 |
| T 43402 | 51 | 79.5 | 76.5 | 60 | 14 | T 43419 | 70 | 108.0 | 105.0 | 70 | 16 |
| T 16884 | 52 | 81.0 | 78.0 | 60 | 14 | | | | | | |

Modul 2

| | | | | | | | | | | | |
|---------|----|----|----|----|----|---------|----|-----|-----|----|----|
| T 16887 | 12 | 28 | 24 | 18 | 10 | T 43426 | 34 | 72 | 68 | 45 | 14 |
| T 16888 | 13 | 30 | 26 | 20 | 10 | T 43427 | 35 | 74 | 70 | 45 | 14 |
| T 16889 | 14 | 32 | 28 | 22 | 10 | T 16903 | 36 | 76 | 72 | 45 | 14 |
| T 16890 | 15 | 34 | 30 | 24 | 10 | T 43428 | 37 | 78 | 74 | 50 | 14 |
| T 16891 | 16 | 36 | 32 | 25 | 10 | T 16904 | 38 | 80 | 76 | 50 | 14 |
| T 16892 | 17 | 38 | 34 | 25 | 10 | T 43429 | 39 | 82 | 78 | 50 | 14 |
| T 16893 | 18 | 40 | 36 | 25 | 10 | T 16905 | 40 | 84 | 80 | 50 | 14 |
| T 16894 | 19 | 42 | 38 | 25 | 10 | T 43430 | 41 | 86 | 82 | 55 | 16 |
| T 16895 | 20 | 44 | 40 | 30 | 10 | T 43431 | 42 | 88 | 84 | 55 | 16 |
| T 16896 | 21 | 46 | 42 | 30 | 12 | T 43432 | 43 | 90 | 86 | 55 | 16 |
| T 16897 | 22 | 48 | 44 | 30 | 12 | T 43433 | 44 | 92 | 88 | 60 | 16 |
| T 16898 | 23 | 50 | 46 | 30 | 12 | T 16906 | 45 | 94 | 90 | 60 | 16 |
| T 16899 | 24 | 52 | 48 | 35 | 12 | T 43434 | 46 | 96 | 92 | 60 | 16 |
| T 16900 | 25 | 54 | 50 | 35 | 12 | T 43435 | 47 | 98 | 94 | 70 | 16 |
| T 43420 | 26 | 56 | 52 | 40 | 12 | T 16907 | 48 | 100 | 96 | 70 | 16 |
| T 43421 | 27 | 58 | 54 | 40 | 12 | T 43436 | 49 | 102 | 98 | 70 | 16 |
| T 16901 | 28 | 60 | 56 | 40 | 12 | T 16908 | 50 | 104 | 100 | 70 | 16 |
| T 43422 | 29 | 62 | 58 | 40 | 14 | T 43437 | 51 | 106 | 102 | 70 | 16 |
| T 16902 | 30 | 64 | 60 | 40 | 14 | T 16909 | 52 | 108 | 104 | 70 | 16 |
| T 43423 | 31 | 66 | 62 | 45 | 14 | T 43438 | 53 | 110 | 106 | 70 | 16 |
| T 43424 | 32 | 68 | 64 | 45 | 14 | T 43439 | 54 | 112 | 108 | 70 | 16 |
| T 43425 | 33 | 70 | 66 | 45 | 14 | T 43440 | 55 | 114 | 110 | 70 | 16 |

Ozubené koleso

Priame ozubenie, uhol záberu 20°

Oce C 43

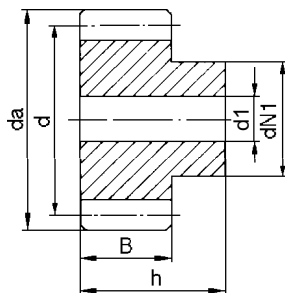

| | B | h |
|-----------|----|----|
| Modul 2 | 20 | 35 |
| Modul 2.5 | 25 | 45 |

Modul 2

| Obj. číslo | zubov | da | d | dN1 | d1 | Obj. číslo | zubov | da | d | dN1 | d1 |
|------------|-------|-----|-----|-----|----|------------|-------|-----|-----|-----|----|
| T 16910 | 56 | 116 | 112 | 70 | 16 | T 43447 | 64 | 132 | 128 | 80 | 16 |
| T 43441 | 57 | 118 | 114 | 70 | 16 | T 43448 | 65 | 134 | 130 | 80 | 16 |
| T 43442 | 58 | 120 | 116 | 70 | 16 | T 43449 | 66 | 136 | 132 | 80 | 16 |
| T 43443 | 59 | 122 | 118 | 70 | 16 | T 43451 | 67 | 138 | 134 | 80 | 16 |
| T 16911 | 60 | 124 | 120 | 70 | 16 | T 43452 | 68 | 140 | 136 | 80 | 16 |
| T 43444 | 61 | 126 | 122 | 80 | 16 | T 43453 | 69 | 142 | 138 | 80 | 16 |
| T 43445 | 62 | 128 | 124 | 80 | 16 | T 43454 | 70 | 144 | 140 | 80 | 16 |
| T 43446 | 63 | 130 | 126 | 80 | 16 | | | | | | |

Modul 2.5

| | | | | | | | | | | | |
|---------|----|------|------|----|----|---------|----|-------|-------|-----|----|
| T 16912 | 12 | 35.0 | 30.0 | 22 | 10 | T 43463 | 37 | 97.5 | 92.5 | 60 | 16 |
| T 16913 | 13 | 37.5 | 32.5 | 25 | 10 | T 16929 | 38 | 100.0 | 95.0 | 60 | 16 |
| T 16914 | 14 | 40.0 | 35.0 | 28 | 10 | T 43464 | 39 | 102.5 | 97.5 | 60 | 16 |
| T 16915 | 15 | 42.5 | 37.5 | 30 | 10 | T 16930 | 40 | 105.0 | 100.0 | 70 | 16 |
| T 16916 | 16 | 45.0 | 40.0 | 32 | 12 | T 43465 | 41 | 107.5 | 102.5 | 70 | 16 |
| T 16917 | 17 | 47.5 | 42.5 | 35 | 12 | T 43466 | 42 | 110.0 | 105.0 | 70 | 16 |
| T 16918 | 18 | 50.0 | 45.0 | 35 | 12 | T 43467 | 43 | 112.5 | 107.5 | 70 | 16 |
| T 16919 | 19 | 52.5 | 47.5 | 35 | 12 | T 43468 | 44 | 115.0 | 110.0 | 70 | 16 |
| T 16920 | 20 | 55.0 | 50.0 | 40 | 12 | T 16931 | 45 | 117.5 | 112.5 | 70 | 16 |
| T 16921 | 21 | 57.5 | 52.5 | 40 | 14 | T 43469 | 46 | 120.0 | 115.0 | 70 | 20 |
| T 16922 | 22 | 60.0 | 55.0 | 45 | 14 | T 43470 | 47 | 122.5 | 117.5 | 80 | 20 |
| T 16923 | 23 | 62.5 | 57.5 | 45 | 14 | T 16932 | 48 | 125.0 | 120.0 | 80 | 20 |
| T 16924 | 24 | 65.0 | 60.0 | 45 | 14 | T 43471 | 49 | 127.5 | 122.5 | 80 | 20 |
| T 16925 | 25 | 67.5 | 62.5 | 50 | 14 | T 16933 | 50 | 130.0 | 125.0 | 80 | 20 |
| T 43455 | 26 | 70.0 | 65.0 | 50 | 14 | T 43472 | 51 | 132.5 | 127.5 | 80 | 20 |
| T 43456 | 27 | 72.5 | 67.5 | 50 | 14 | T 16934 | 52 | 135.0 | 130.0 | 90 | 20 |
| T 16926 | 28 | 75.0 | 70.0 | 50 | 14 | T 43473 | 53 | 137.5 | 132.5 | 90 | 20 |
| T 43457 | 29 | 77.5 | 72.5 | 50 | 14 | T 43474 | 54 | 140.0 | 135.0 | 90 | 20 |
| T 16927 | 30 | 80.0 | 75.0 | 55 | 14 | T 43475 | 55 | 142.5 | 137.5 | 90 | 20 |
| T 43458 | 31 | 82.5 | 77.5 | 55 | 16 | T 16935 | 56 | 145.0 | 140.0 | 100 | 20 |
| T 43459 | 32 | 85.0 | 80.0 | 55 | 16 | T 43476 | 57 | 147.5 | 142.5 | 100 | 20 |
| T 43460 | 33 | 87.5 | 82.5 | 55 | 16 | T 43477 | 58 | 150.0 | 145.0 | 100 | 20 |
| T 43461 | 34 | 90.0 | 85.0 | 55 | 16 | T 43478 | 59 | 152.5 | 147.5 | 100 | 20 |
| T 43462 | 35 | 92.5 | 87.5 | 60 | 16 | T 43479 | 60 | 155.0 | 150.0 | 100 | 20 |
| T 16928 | 36 | 95.0 | 90.0 | 60 | 16 | | | | | | |

Ozubené koleso

Priame ozubenie, uhol záberu 20°

Oce C 43

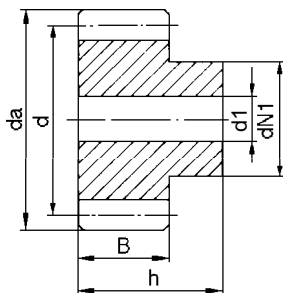

| | B | h |
|---------|----|----|
| Modul 3 | 30 | 50 |
| Modul 4 | 40 | 60 |

Modul 3

| Obj. číslo | zubov | da | d | dN1 | d1 | Obj. číslo | zubov | da | d | dN1 | d1 |
|------------|-------|----|----|-----|----|------------|-------|-----|-----|-----|----|
| T 16936 | 12 | 42 | 36 | 27 | 12 | T 43483 | 31 | 99 | 93 | 60 | 16 |
| T 16937 | 13 | 45 | 39 | 30 | 12 | T 43484 | 32 | 102 | 96 | 70 | 16 |
| T 16938 | 14 | 48 | 42 | 35 | 12 | T 43485 | 33 | 105 | 99 | 70 | 16 |
| T 16939 | 15 | 51 | 45 | 35 | 12 | T 43486 | 34 | 108 | 102 | 70 | 16 |
| T 16940 | 16 | 54 | 48 | 38 | 14 | T 43487 | 35 | 111 | 105 | 70 | 16 |
| T 16941 | 17 | 57 | 51 | 42 | 14 | T 16952 | 36 | 114 | 108 | 70 | 20 |
| T 16942 | 18 | 60 | 54 | 45 | 14 | T 43488 | 37 | 117 | 111 | 70 | 20 |
| T 16943 | 19 | 63 | 57 | 45 | 14 | T 16953 | 38 | 120 | 114 | 80 | 20 |
| T 16944 | 20 | 66 | 60 | 45 | 14 | T 43489 | 39 | 123 | 117 | 80 | 20 |
| T 16945 | 21 | 69 | 63 | 45 | 16 | T 16954 | 40 | 126 | 120 | 80 | 20 |
| T 16946 | 22 | 72 | 66 | 50 | 16 | T 43490 | 41 | 129 | 123 | 80 | 20 |
| T 16947 | 23 | 75 | 69 | 50 | 16 | T 43491 | 42 | 132 | 126 | 80 | 20 |
| T 16948 | 24 | 78 | 72 | 50 | 16 | T 43492 | 43 | 135 | 129 | 80 | 20 |
| T 16949 | 25 | 81 | 75 | 60 | 16 | T 43493 | 44 | 138 | 132 | 90 | 20 |
| T 43480 | 26 | 84 | 78 | 60 | 16 | T 16955 | 45 | 141 | 135 | 90 | 20 |
| T 43481 | 27 | 87 | 81 | 60 | 16 | T 43494 | 46 | 144 | 138 | 90 | 20 |
| T 16950 | 28 | 90 | 84 | 60 | 16 | T 43495 | 47 | 147 | 141 | 100 | 20 |
| T 43482 | 29 | 93 | 87 | 60 | 16 | T 16956 | 48 | 150 | 144 | 100 | 20 |
| T 16951 | 30 | 96 | 90 | 60 | 16 | | | | | | |

Modul 4

| | | | | | | | | | | | |
|---------|----|-----|----|----|----|---------|----|-----|-----|----|----|
| T 16957 | 12 | 56 | 48 | 35 | 14 | T 16970 | 25 | 108 | 100 | 75 | 20 |
| T 16958 | 13 | 60 | 52 | 40 | 14 | T 43496 | 26 | 112 | 104 | 75 | 20 |
| T 16959 | 14 | 64 | 56 | 45 | 14 | T 43497 | 27 | 116 | 108 | 75 | 20 |
| T 16960 | 15 | 68 | 60 | 45 | 14 | T 16971 | 28 | 120 | 112 | 75 | 20 |
| T 16961 | 16 | 72 | 64 | 50 | 16 | T 43498 | 29 | 124 | 116 | 75 | 20 |
| T 16962 | 17 | 76 | 68 | 50 | 16 | T 16972 | 30 | 128 | 120 | 75 | 20 |
| T 16963 | 18 | 80 | 72 | 50 | 16 | T 43499 | 31 | 132 | 124 | 80 | 20 |
| T 16964 | 19 | 84 | 76 | 60 | 16 | T 43500 | 32 | 136 | 128 | 80 | 20 |
| T 16965 | 20 | 88 | 80 | 60 | 16 | T 43501 | 33 | 140 | 132 | 80 | 20 |
| T 16966 | 21 | 92 | 84 | 70 | 16 | T 43502 | 34 | 144 | 136 | 80 | 20 |
| T 16967 | 22 | 96 | 88 | 70 | 16 | T 43503 | 35 | 148 | 140 | 80 | 20 |
| T 16968 | 23 | 100 | 92 | 75 | 20 | T 16973 | 36 | 152 | 144 | 80 | 25 |
| T 16969 | 24 | 104 | 96 | 75 | 20 | | | | | | |

Ozubené koleso

Priame ozubenie, uhol záberu 20°

Oce C 43

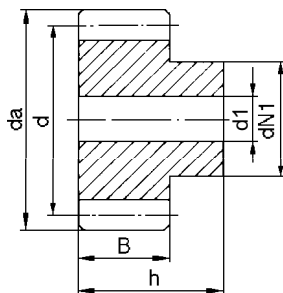

| | B | h |
|---------|----|----|
| Modul 5 | 50 | 75 |
| Modul 6 | 60 | 80 |

Modul 5

| Obj. číslo | zubov | da | d | dN1 | d1 | Obj. číslo | zubov | da | d | dN1 | d1 |
|------------|-------|-----|-----|-----|----|------------|-------|-----|-----|-----|----|
| T 16974 | 12 | 70 | 60 | 45 | 20 | T 16984 | 22 | 120 | 110 | 80 | 20 |
| T 16975 | 13 | 75 | 65 | 50 | 20 | T 16985 | 23 | 125 | 115 | 90 | 20 |
| T 16976 | 14 | 80 | 70 | 55 | 20 | T 16986 | 24 | 130 | 120 | 90 | 20 |
| T 16977 | 15 | 85 | 75 | 60 | 20 | T 16987 | 25 | 135 | 125 | 90 | 20 |
| T 16978 | 16 | 90 | 80 | 65 | 20 | T 43504 | 26 | 140 | 130 | 100 | 20 |
| T 16979 | 17 | 95 | 85 | 70 | 20 | T 43506 | 27 | 145 | 135 | 100 | 20 |
| T 16980 | 18 | 100 | 90 | 70 | 20 | T 18533 | 28 | 150 | 140 | 100 | 25 |
| T 16981 | 19 | 105 | 95 | 70 | 20 | T 43507 | 29 | 155 | 145 | 110 | 25 |
| T 16982 | 20 | 110 | 100 | 80 | 20 | T 43508 | 30 | 160 | 150 | 110 | 25 |
| T 16983 | 21 | 115 | 105 | 80 | 20 | | | | | | |

Modul 6

| | | | | | | | | | | | |
|---------|----|-----|----|----|----|---------|----|-----|-----|-----|----|
| T 16989 | 12 | 84 | 72 | 54 | 20 | T 16995 | 18 | 120 | 108 | 80 | 20 |
| T 16990 | 13 | 90 | 78 | 60 | 20 | T 16997 | 20 | 132 | 120 | 90 | 20 |
| T 16992 | 15 | 102 | 90 | 70 | 20 | T 17001 | 24 | 156 | 144 | 110 | 25 |
| T 16993 | 16 | 108 | 95 | 75 | 20 | T 17002 | 25 | 162 | 150 | 110 | 25 |

Ozubené koleso

Priame ozubenie, uhol záberu 20°

Oce C 43

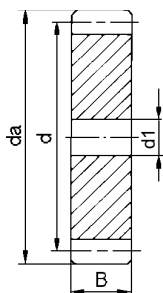

| | B |
|-----------|----|
| Modul 1 | 15 |
| Modul 1.5 | 17 |
| Modul 2 | 20 |
| Modul 2.5 | 25 |

Modul 1

| Obj. číslo | zubov | da | d | d1 | Obj. číslo | zubov | da | d | d1 |
|------------|-------|----|----|----|------------|-------|-----|-----|----|
| T 43509 | 72 | 74 | 72 | 12 | T 17006 | 95 | 97 | 95 | 12 |
| T 43510 | 75 | 77 | 75 | 12 | T 43513 | 100 | 102 | 100 | 12 |
| T 17004 | 76 | 78 | 76 | 12 | T 43514 | 110 | 112 | 110 | 12 |
| T 17005 | 80 | 82 | 80 | 12 | T 43515 | 114 | 116 | 114 | 12 |
| T 43511 | 85 | 87 | 85 | 12 | T 43516 | 120 | 122 | 120 | 12 |
| T 43512 | 90 | 92 | 90 | 12 | T 43517 | 127 | 129 | 127 | 12 |

Modul 1.5

| | | | | | | | | | |
|---------|----|-------|-------|----|---------|-----|-------|-------|----|
| T 43519 | 72 | 111.0 | 108.0 | 16 | T 17009 | 95 | 145.5 | 142.5 | 16 |
| T 43520 | 75 | 115.5 | 112.5 | 16 | T 43524 | 100 | 153.0 | 150.0 | 16 |
| T 17007 | 76 | 117.0 | 114.0 | 16 | T 43525 | 110 | 168.0 | 165.0 | 16 |
| T 17008 | 80 | 123.0 | 120.0 | 16 | T 43526 | 114 | 174.0 | 171.0 | 16 |
| T 43522 | 85 | 130.5 | 127.5 | 16 | T 43527 | 120 | 183.0 | 180.0 | 16 |
| T 43523 | 90 | 138.0 | 135.0 | 16 | T 43528 | 127 | 193.5 | 190.5 | 16 |

Modul 2

| | | | | | | | | | |
|---------|----|-----|-----|----|---------|-----|-----|-----|----|
| T 43530 | 72 | 148 | 144 | 16 | T 17012 | 95 | 194 | 190 | 20 |
| T 43531 | 75 | 154 | 150 | 20 | T 43534 | 100 | 204 | 200 | 20 |
| T 17010 | 76 | 156 | 152 | 20 | T 43535 | 110 | 224 | 220 | 20 |
| T 17011 | 80 | 164 | 160 | 20 | T 43536 | 114 | 232 | 228 | 20 |
| T 43532 | 85 | 174 | 170 | 20 | T 43537 | 120 | 244 | 240 | 20 |
| T 43533 | 90 | 184 | 180 | 20 | T 43538 | 127 | 258 | 254 | 20 |

Modul 2.5

| | | | | | | | | | |
|---------|----|-------|-------|----|---------|-----|-------|-------|----|
| T 43539 | 65 | 167.5 | 162.5 | 20 | T 43544 | 90 | 230.0 | 225.0 | 25 |
| T 43540 | 70 | 180.0 | 175.0 | 20 | T 17016 | 95 | 242.5 | 237.5 | 25 |
| T 43541 | 72 | 185.0 | 180.0 | 20 | T 43545 | 100 | 255.0 | 250.0 | 25 |
| T 43542 | 75 | 192.5 | 187.5 | 20 | T 43546 | 110 | 280.0 | 275.0 | 25 |
| T 17014 | 76 | 195.0 | 190.0 | 20 | T 43552 | 114 | 290.0 | 285.0 | 25 |
| T 17015 | 80 | 205.0 | 200.0 | 25 | T 43553 | 120 | 305.0 | 300.0 | 25 |
| T 43543 | 85 | 217.5 | 212.5 | 25 | T 43554 | 127 | 322.5 | 317.5 | 25 |

Ozubené koleso

Priame ozubenie, uhol záberu 20°

Oce C 43

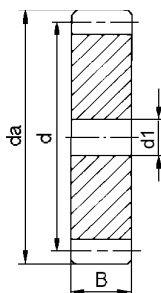

| | B |
|---------|----|
| Modul 3 | 30 |
| Modul 4 | 40 |
| Modul 5 | 50 |
| Modul 6 | 60 |

Modul 3

| Obj. číslo | zubov | da | d | d1 | Obj. číslo | zubov | da | d | d1 |
|------------|-------|-----|-----|----|------------|-------|-----|-----|----|
| T 17017 | 50 | 156 | 150 | 20 | T 17022 | 80 | 246 | 240 | 25 |
| T 17018 | 52 | 162 | 156 | 20 | T 43561 | 85 | 261 | 255 | 25 |
| T 43555 | 55 | 171 | 165 | 20 | T 43562 | 90 | 276 | 270 | 25 |
| T 43556 | 57 | 177 | 171 | 20 | T 17023 | 95 | 291 | 285 | 25 |
| T 17020 | 60 | 186 | 180 | 20 | T 43563 | 100 | 306 | 300 | 25 |
| T 43557 | 65 | 201 | 195 | 20 | T 43564 | 110 | 336 | 330 | 25 |
| T 43558 | 70 | 216 | 210 | 25 | T 43565 | 114 | 348 | 342 | 30 |
| T 43559 | 72 | 222 | 216 | 25 | T 43566 | 120 | 366 | 360 | 30 |
| T 43560 | 75 | 231 | 225 | 25 | T 43567 | 127 | 387 | 381 | 30 |
| T 17021 | 76 | 234 | 228 | 25 | | | | | |

Modul 4

| | | | | | | | | | |
|---------|----|-----|-----|----|---------|-----|-----|-----|----|
| T 17024 | 38 | 160 | 152 | 25 | T 43572 | 70 | 288 | 280 | 25 |
| T 17025 | 40 | 168 | 160 | 25 | T 43574 | 75 | 308 | 300 | 25 |
| T 17026 | 45 | 188 | 180 | 25 | T 17032 | 76 | 312 | 304 | 30 |
| T 17027 | 48 | 200 | 192 | 25 | T 17033 | 80 | 328 | 320 | 30 |
| T 17028 | 50 | 208 | 200 | 25 | T 43575 | 85 | 348 | 340 | 30 |
| T 17029 | 52 | 216 | 208 | 25 | T 43577 | 90 | 368 | 360 | 30 |
| T 43568 | 55 | 228 | 220 | 25 | T 17034 | 95 | 388 | 380 | 30 |
| T 43569 | 57 | 236 | 228 | 25 | T 43578 | 100 | 408 | 400 | 30 |
| T 17031 | 60 | 248 | 240 | 25 | T 43579 | 110 | 448 | 440 | 30 |
| T 43570 | 65 | 268 | 260 | 25 | T 43580 | 114 | 464 | 456 | 30 |

Modul 5

| | | | | | | | | | |
|---------|----|-----|-----|----|---------|-----|-----|-----|----|
| T 43581 | 32 | 170 | 160 | 25 | T 43586 | 65 | 335 | 325 | 30 |
| T 43582 | 35 | 185 | 175 | 25 | T 43587 | 70 | 360 | 350 | 30 |
| T 17038 | 38 | 200 | 190 | 25 | T 43589 | 75 | 385 | 375 | 30 |
| T 17039 | 40 | 210 | 200 | 25 | T 17046 | 76 | 390 | 380 | 30 |
| T 17040 | 45 | 235 | 225 | 25 | T 17047 | 80 | 410 | 400 | 30 |
| T 17041 | 48 | 250 | 240 | 25 | T 43590 | 85 | 435 | 425 | 30 |
| T 17042 | 50 | 260 | 250 | 30 | T 43591 | 90 | 460 | 450 | 30 |
| T 17043 | 52 | 270 | 260 | 30 | T 17048 | 95 | 485 | 475 | 30 |
| T 43584 | 55 | 285 | 275 | 30 | T 43593 | 100 | 510 | 500 | 30 |
| T 43585 | 57 | 295 | 285 | 30 | T 43594 | 110 | 560 | 550 | 30 |
| T 17045 | 60 | 310 | 300 | 30 | T 43595 | 114 | 580 | 570 | 30 |

Modul 6

| | | | | | | | | | |
|---------|----|-----|-----|----|---------|----|-----|-----|----|
| T 17049 | 28 | 180 | 168 | 25 | T 43598 | 35 | 222 | 210 | 25 |
| T 17050 | 30 | 192 | 180 | 25 | T 17052 | 38 | 240 | 220 | 25 |
| T 43597 | 32 | 204 | 192 | 25 | T 17053 | 40 | 252 | 240 | 25 |

Kuže ové súkolie 1:1

Priame ozubenie, uhol záberu 20°

Oce C 43

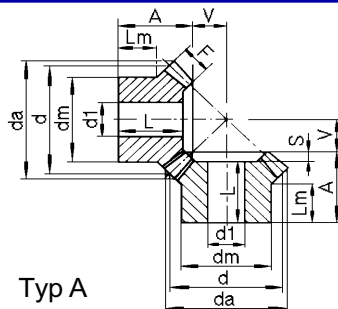

Typ A

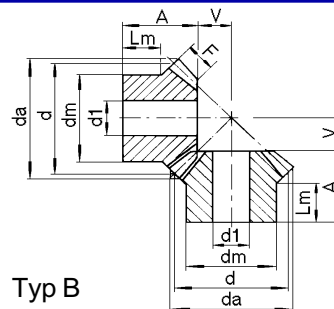

Typ B

Prevodový pomer 1:1

| Obj. číslo | Modul | zubov | Typ | d | da | F | A | V | dm | d1 | L | S | Lm |
|------------|-------|-------|------|-------|-------|-------|-------|-------|-------|-------|-------|-------|------|
| T 43675 | 1 | 16 | B | 16.0 | 17.40 | 4.0 | 11.20 | 4.80 | 13.3 | 4 | - | - | 6.7 |
| T 43676 | | 19 | B | 19.0 | 20.40 | 4.0 | 11.80 | 6.20 | 15.3 | 4 | - | - | 6.6 |
| T 43677 | | 22 | B | 22.0 | 23.40 | 4.7 | 12.80 | 7.20 | 16.3 | 5 | - | - | 6.1 |
| T 43678 | | 26 | B | 26.0 | 27.40 | 5.5 | 13.30 | 8.70 | 20.3 | 5 | - | - | 7.0 |
| T 43679 | | 30 | B | 30.0 | 31.40 | 6.4 | 16.00 | 10.00 | 20.3 | 5 | - | - | 8.0 |
| T 43604 | | 16 | A | 24.0 | 26.10 | 8.0 | 18.00 | 5.80 | 18.0 | 8 | 17.00 | 1.0 | 8.9 |
| T 43680 | | 16 | B | 24.0 | 26.10 | 6.0 | 18.90 | 7.10 | 20.3 | 8 | - | - | 12.2 |
| T 43681 | | 19 | B | 28.5 | 30.60 | 7.0 | 21.30 | 8.70 | 20.3 | 8 | - | - | 11.6 |
| T 43605 | | 20 | A | 30.0 | 32.10 | 8.0 | 20.00 | 8.70 | 22.0 | 10 | 18.00 | 2.0 | 9.8 |
| T 64693 | | 1.5 | 22 | A | 33.0 | 35.10 | 8.0 | 20.00 | 10.20 | 25.0 | 10 | 18.00 | 2.0 |
| T 43682 | 22 | B | 33.0 | 35.10 | 7.5 | 22.50 | 10.50 | 25.3 | 8 | - | - | 12.7 | |
| T 43606 | 25 | A | 37.5 | 39.60 | 8.0 | 23.00 | 12.40 | 28.0 | 10 | 21.00 | 2.0 | 12.0 | |
| T 43683 | 26 | B | 39.0 | 41.10 | 8.5 | 23.20 | 12.80 | 28.3 | 8 | - | - | 12.0 | |
| T 43607 | 30 | A | 45.0 | 47.10 | 10.0 | 25.00 | 14.70 | 30.0 | 12 | 22.50 | 2.5 | 12.0 | |
| T 43684 | 30 | B | 45.0 | 47.10 | 10.0 | 27.20 | 14.80 | 30.0 | 12 | - | - | 12.1 | |
| T 43608 | 16 | A | 32.0 | 34.80 | 9.0 | 20.00 | 8.80 | 25.0 | 10 | 17.00 | 3.0 | 9.3 | |
| T 43685 | 16 | B | 32.0 | 34.80 | 8.0 | 23.50 | 9.50 | 25.3 | 8 | - | - | 13.6 | |
| T 43686 | 19 | B | 38.0 | 40.80 | 9.0 | 24.20 | 11.80 | 25.3 | 8 | - | - | 12.0 | |
| T 43609 | 20 | A | 40.0 | 42.80 | 12.0 | 25.00 | 10.70 | 32.0 | 10 | 22.00 | 3.0 | 12.0 | |
| T 64694 | 2 | 22 | A | 44.0 | 46.80 | 12.0 | 25.00 | 12.70 | 36.0 | 10 | 22.00 | 3.0 | 17.7 |
| T 43687 | 22 | B | 44.0 | 46.80 | 10.0 | 27.90 | 14.10 | 30.3 | 10 | - | - | 14.0 | |
| T 43610 | 25 | A | 50.0 | 52.80 | 14.0 | 28.00 | 14.30 | 40.0 | 12 | 25.00 | 3.0 | 12.3 | |
| T 43688 | 26 | B | 52.0 | 54.80 | 12.0 | 31.40 | 16.60 | 35.3 | 12 | - | - | 13.7 | |
| T 43611 | 30 | A | 60.0 | 62.80 | 16.0 | 30.00 | 17.80 | 50.0 | 12 | 27.00 | 3.0 | 12.8 | |
| T 43689 | 30 | B | 60.0 | 62.80 | 13.0 | 34.10 | 19.90 | 40.3 | 12 | - | - | 17.0 | |
| T 43612 | 16 | A | 40.0 | 43.50 | 10.0 | 25.50 | 11.80 | 32.0 | 12 | 22.00 | 3.5 | 13.3 | |
| T 43690 | 16 | B | 40.0 | 43.50 | 10.0 | 28.10 | 11.90 | 30.3 | 12 | - | - | 15.2 | |
| T 43691 | 19 | B | 47.5 | 51.00 | 11.0 | 27.10 | 14.90 | 35.3 | 12 | - | - | 13.0 | |
| T 43613 | 20 | A | 50.0 | 53.50 | 12.0 | 30.50 | 15.40 | 40.0 | 12 | 27.00 | 3.5 | 16.0 | |
| T 64695 | 2.5 | 22 | A | 55.0 | 58.50 | 12.0 | 30.50 | 17.80 | 45.0 | 12 | 27.00 | 3.5 | 15.9 |
| T 43692 | 22 | B | 55.0 | 58.50 | 12.0 | 30.10 | 17.90 | 45.3 | 12 | - | - | 15.7 | |
| T 43614 | 25 | A | 62.5 | 66.00 | 15.0 | 33.50 | 19.50 | 50.0 | 15 | 30.00 | 3.5 | 16.0 | |
| T 43693 | 26 | B | 65.0 | 68.50 | 15.0 | 33.20 | 20.80 | 45.3 | 15 | - | - | 16.0 | |
| T 43615 | 30 | A | 75.0 | 78.50 | 18.0 | 35.50 | 23.60 | 55.0 | 15 | 32.00 | 3.5 | 16.0 | |
| T 43694 | 30 | B | 75.0 | 78.50 | 16.0 | 39.00 | 25.00 | 50.3 | 15 | - | - | 20.0 | |
| T 43616 | 16 | A | 48.0 | 52.20 | 12.0 | 30.00 | 14.20 | 40.0 | 15 | 26.00 | 4.0 | 16.2 | |
| T 43695 | 16 | B | 48.0 | 52.20 | 12.0 | 31.70 | 14.30 | 40.3 | 12 | - | - | 18.1 | |
| T 43696 | 19 | B | 57.0 | 61.20 | 13.0 | 36.00 | 18.00 | 40.3 | 14 | - | - | 17.1 | |
| T 43617 | 20 | A | 60.0 | 64.20 | 18.0 | 35.00 | 16.10 | 45.0 | 15 | 31.00 | 4.0 | 13.6 | |
| T 64696 | 3 | 22 | A | 66.0 | 70.20 | 18.0 | 35.00 | 19.00 | 50.0 | 15 | 31.00 | 4.0 | 13.0 |
| T 43697 | 22 | B | 66.0 | 70.20 | 15.0 | 36.90 | 21.10 | 50.3 | 15 | - | - | 17.1 | |
| T 43618 | 25 | A | 75.0 | 79.20 | 20.0 | 38.00 | 22.10 | 55.0 | 15 | 34.00 | 4.0 | 16.0 | |
| T 43698 | 26 | B | 78.0 | 82.20 | 17.0 | 38.40 | 25.60 | 50.3 | 15 | - | - | 18.0 | |
| T 43619 | 30 | A | 90.0 | 94.20 | 22.0 | 40.00 | 28.10 | 60.0 | 20 | 36.00 | 4.0 | 19.0 | |
| T 43699 | 30 | B | 90.0 | 94.20 | 19.0 | 43.80 | 30.20 | 60.3 | 20 | - | - | 22.0 | |

Kuže ové súkolie 1:1

Priame ozubenie, uhol záberu 20°

Oce C 43

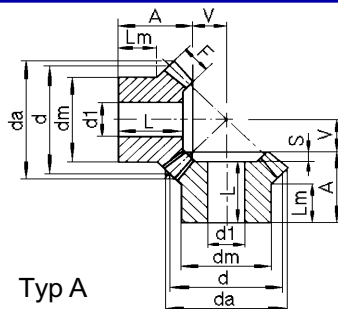

Typ A

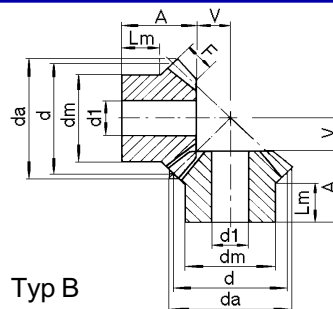

Typ B

Prevodový pomer 1:1

| Obj. číslo | Modul | zubov | Typ | d | da | F | A | V | dm | d1 | L | S | Lm |
|------------|-------|-------|-----|-------|--------|------|-------|-------|-------|----|-------|-----|------|
| T 43620 | 3.5 | 16 | A | 56.0 | 60.90 | 16.0 | 35.50 | 15.30 | 45.0 | 15 | 31.00 | 4.5 | 17.2 |
| T 43700 | | 16 | B | 56.0 | 60.90 | 14.0 | 36.40 | 16.60 | 45.3 | 15 | - | - | 19.8 |
| T 43701 | | 19 | B | 66.5 | 71.40 | 15.0 | 36.90 | 21.10 | 50.3 | 15 | - | - | 18.0 |
| T 43621 | | 20 | A | 70.0 | 74.90 | 22.0 | 40.50 | 18.10 | 55.0 | 15 | 36.00 | 4.5 | 19.0 |
| T 64697 | | 22 | A | 77.0 | 81.90 | 22.0 | 40.50 | 21.50 | 60.0 | 15 | 36.00 | 4.5 | 18.0 |
| T 43702 | | 22 | B | 77.0 | 81.90 | 17.0 | 39.10 | 24.90 | 55.3 | 20 | - | - | 18.0 |
| T 43622 | | 25 | A | 87.5 | 92.40 | 26.0 | 43.50 | 24.00 | 65.0 | 20 | 39.00 | 4.5 | 18.0 |
| T 43703 | | 26 | B | 91.0 | 95.90 | 20.0 | 42.20 | 29.80 | 60.3 | 20 | - | - | 20.0 |
| T 43623 | | 30 | A | 105.0 | 109.90 | 30.0 | 45.50 | 29.90 | 70.0 | 20 | 41.00 | 4.5 | 17.0 |
| T 43704 | | 30 | B | 105.0 | 110.00 | 23.0 | 47.30 | 34.70 | 70.3 | 20 | 43.00 | - | 22.0 |
| T 43637 | 4 | 16 | A | 56.0 | 60.90 | 16.0 | 35.50 | 15.30 | 45.0 | 15 | 31.00 | 4.5 | 17.2 |
| T 43705 | | 16 | B | 64.0 | 69.70 | 15.0 | 44.30 | 19.70 | 50.3 | 15 | - | - | 25.1 |
| T 43706 | | 19 | B | 76.0 | 81.70 | 18.0 | 44.40 | 23.60 | 55.3 | 18 | - | - | 22.0 |
| T 43638 | | 20 | A | 70.0 | 74.90 | 22.0 | 40.50 | 18.10 | 55.0 | 15 | 36.00 | 4.5 | 19.0 |
| T 64698 | | 22 | A | 77.0 | 81.90 | 22.0 | 40.50 | 21.50 | 60.0 | 15 | 36.00 | 4.5 | 18.0 |
| T 43707 | | 22 | B | 88.0 | 93.70 | 20.0 | 45.90 | 28.10 | 60.3 | 18 | - | - | 22.0 |
| T 43639 | | 25 | A | 87.5 | 92.40 | 26.0 | 43.50 | 24.00 | 65.0 | 20 | 39.00 | 4.5 | 18.0 |
| T 43708 | | 26 | B | 104.0 | 109.70 | 23.0 | 48.00 | 34.00 | 70.3 | 20 | 43.00 | - | 22.0 |
| T 43640 | | 30 | A | 105.0 | 109.90 | 30.0 | 45.50 | 29.90 | 70.0 | 20 | 41.00 | 4.5 | 17.0 |
| T 43709 | | 30 | B | 120.0 | 125.70 | 26.0 | 54.20 | 39.80 | 80.3 | 25 | 49.00 | - | 25.0 |
| T 43642 | 4.5 | 16 | A | 72.0 | 78.30 | 20.0 | 43.00 | 20.00 | 55.0 | 18 | 37.00 | 6.0 | 18.5 |
| T 43710 | | 16 | B | 72.0 | 78.40 | 17.5 | 46.30 | 21.70 | 55.3 | 18 | - | - | 25.0 |
| T 43711 | | 19 | B | 85.5 | 91.80 | 20.0 | 47.30 | 26.70 | 60.3 | 20 | - | - | 25.0 |
| T 43644 | | 20 | A | 90.0 | 96.30 | 28.0 | 48.00 | 23.50 | 65.0 | 20 | 42.00 | 6.0 | 18.0 |
| T 64699 | | 22 | A | 99.0 | 105.30 | 28.0 | 48.00 | 27.80 | 70.0 | 20 | 42.00 | 6.0 | 18.0 |
| T 43712 | | 22 | B | 99.0 | 105.30 | 22.0 | 50.10 | 31.90 | 70.3 | 20 | - | - | 25.0 |
| T 43645 | | 25 | A | 112.5 | 118.80 | 32.0 | 50.00 | 31.80 | 75.0 | 20 | 44.00 | 6.0 | 18.0 |
| T 43713 | | 26 | B | 117.0 | 123.30 | 25.0 | 53.20 | 38.80 | 75.3 | 20 | 45.00 | - | 25.0 |
| T 43646 | | 30 | A | 135.0 | 141.30 | 35.0 | 53.00 | 40.80 | 90.0 | 25 | 47.00 | 6.0 | 17.0 |
| T 43714 | | 30 | B | 135.0 | 141.40 | 29.0 | 60.00 | 45.00 | 80.3 | 25 | 54.00 | - | 28.0 |
| T 43647 | 5 | 16 | A | 80.0 | 87.00 | 22.0 | 45.50 | 22.30 | 60.0 | 20 | 39.00 | 6.5 | 17.8 |
| T 43715 | | 16 | B | 80.0 | 87.10 | 18.0 | 48.90 | 25.10 | 60.3 | 20 | - | - | 25.0 |
| T 43716 | | 19 | B | 95.0 | 102.10 | 22.0 | 52.20 | 29.80 | 60.3 | 20 | - | - | 25.0 |
| T 43648 | | 20 | A | 100.0 | 107.10 | 30.0 | 50.50 | 26.80 | 70.0 | 20 | 44.00 | 6.5 | 18.5 |
| T 64700 | | 22 | A | 110.0 | 117.10 | 30.0 | 50.50 | 31.70 | 80.0 | 20 | 44.00 | 6.5 | 18.5 |
| T 43717 | | 22 | B | 110.0 | 117.10 | 24.0 | 58.20 | 35.80 | 80.3 | 20 | 52.00 | - | 30.0 |
| T 43649 | | 25 | A | 125.0 | 132.10 | 35.0 | 54.50 | 35.70 | 90.0 | 20 | 48.00 | 6.5 | 18.5 |
| T 43718 | | 26 | B | 130.0 | 137.10 | 29.0 | 62.70 | 42.30 | 80.3 | 20 | 57.00 | - | 30.0 |
| T 43650 | | 30 | A | 150.0 | 157.10 | 38.0 | 56.50 | 45.90 | 110.0 | 30 | 50.00 | 6.5 | 18.0 |
| T 43719 | | 30 | B | 150.0 | 157.10 | 32.0 | 68.90 | 50.10 | 80.3 | 30 | 63.00 | - | 35.0 |

Kuže ové súkolie 1:2

Priame ozubenie, uhol záberu 20°

Oce C 43

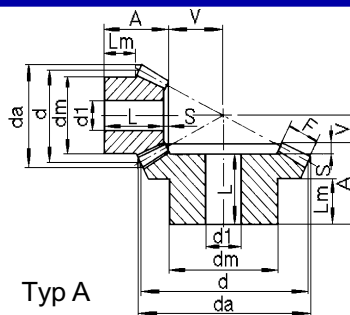

Typ A

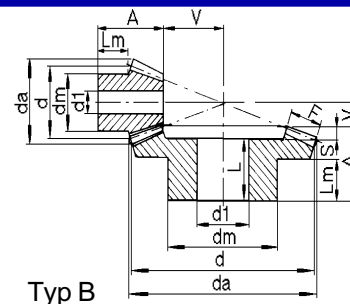

Typ B

Prevodový pomer 1:2

| Obj. číslo | Modul | zubov | Typ | d | da | F | A | V | dm | d1 | L | S | Lm |
|------------|-------|-------|-----|-------|--------|------|------|-------|------|----|------|-----|------|
| T 43720 | 1 | 15 | B | 15.0 | 17.40 | 5.0 | 11.9 | 10.10 | 13.3 | 4 | - | - | 6.6 |
| | | 30 | | 30.0 | 30.60 | 5.0 | 15.1 | 4.90 | 20.3 | 5 | 14.0 | 1.1 | 9.0 |
| T 43651 | 1.5 | 16 | A | 24.0 | 26.70 | 8.0 | 18.5 | 16.40 | 21.0 | 10 | 17.0 | 1.5 | 10.3 |
| | | 32 | | 48.0 | 49.30 | 8.0 | 20.0 | 7.50 | 32.0 | 12 | 17.5 | 2.5 | 10.0 |
| T 43721 | 1.5 | 15 | B | 22.5 | 26.10 | 9.0 | 21.1 | 13.90 | 20.3 | 8 | - | - | 12.0 |
| | | 30 | | 45.0 | 45.90 | 9.0 | 25.2 | 6.80 | 32.3 | 8 | 23.0 | 2.2 | 16.0 |
| T 43652 | 2 | 16 | A | 32.0 | 35.60 | 10.0 | 23.0 | 22.40 | 27.0 | 10 | 21.0 | 2.0 | 12.2 |
| | | 32 | | 64.0 | 65.80 | 10.0 | 25.0 | 10.20 | 40.0 | 12 | 22.0 | 3.0 | 10.0 |
| T 43722 | 2 | 15 | B | 30.0 | 34.80 | 11.5 | 26.0 | 19.00 | 25.3 | 8 | - | - | 13.8 |
| | | 30 | | 60.0 | 61.20 | 11.5 | 29.8 | 9.20 | 40.3 | 12 | 27.0 | 2.8 | 18.0 |
| T 43653 | 2.5 | 16 | A | 40.0 | 44.40 | 12.0 | 27.5 | 28.50 | 34.0 | 12 | 25.0 | 2.5 | 14.4 |
| | | 32 | | 80.0 | 82.20 | 12.0 | 30.0 | 13.00 | 50.0 | 15 | 26.5 | 3.5 | 15.0 |
| T 43723 | 2.5 | 15 | B | 37.5 | 43.50 | 15.0 | 31.8 | 23.20 | 32.3 | 12 | - | - | 16.2 |
| | | 30 | | 75.0 | 76.50 | 15.0 | 33.7 | 11.30 | 45.3 | 15 | 30.0 | 3.7 | 20.0 |
| T 43654 | 3 | 16 | A | 48.0 | 53.40 | 15.0 | 28.0 | 33.60 | 40.0 | 15 | 25.0 | 3.0 | 11.6 |
| | | 32 | | 96.0 | 98.70 | 15.0 | 35.0 | 15.40 | 60.0 | 15 | 30.5 | 4.5 | 15.0 |
| T 43724 | 3 | 15 | B | 45.0 | 52.20 | 17.0 | 37.3 | 28.70 | 40.3 | 12 | - | - | 19.8 |
| | | 30 | | 90.0 | 91.80 | 17.0 | 42.1 | 13.90 | 55.3 | 15 | 38.0 | 4.1 | 25.0 |
| T 43655 | 3.5 | 16 | A | 56.0 | 62.30 | 18.0 | 33.5 | 38.80 | 48.0 | 15 | 30.5 | 3.0 | 14.4 |
| | | 32 | | 112.0 | 115.10 | 18.0 | 40.0 | 17.70 | 70.0 | 20 | 35.0 | 5.0 | 19.0 |
| T 43725 | 3.5 | 15 | B | 52.5 | 60.90 | 20.5 | 46.1 | 32.90 | 45.3 | 15 | - | - | 24.7 |
| | | 30 | | 105.0 | 107.10 | 20.5 | 45.0 | 16.00 | 60.3 | 20 | 40.0 | 5.0 | 25.0 |
| T 43656 | 4 | 16 | A | 64.0 | 71.10 | 20.0 | 36.0 | 44.80 | 50.0 | 20 | 32.0 | 4.0 | 13.4 |
| | | 32 | | 128.0 | 131.60 | 20.0 | 45.0 | 20.50 | 80.0 | 20 | 39.5 | 5.5 | 23.0 |
| T 43726 | 4 | 15 | B | 60.0 | 69.60 | 22.5 | 48.6 | 38.40 | 50.3 | 20 | - | - | 24.6 |
| | | 30 | | 120.0 | 122.30 | 22.5 | 57.3 | 18.70 | 80.3 | 20 | 52.0 | 5.3 | 35.0 |
| T 43657 | 4.5 | 16 | A | 72.0 | 80.10 | 22.0 | 39.5 | 50.90 | 60.0 | 20 | 35.0 | 4.5 | 15.4 |
| | | 32 | | 144.0 | 148.00 | 22.0 | 50.0 | 23.20 | 80.0 | 25 | 43.5 | 6.5 | 24.0 |
| T 43727 | 4.5 | 15 | B | 67.5 | 78.30 | 26.0 | 51.4 | 42.60 | 60.3 | 20 | - | - | 24.7 |
| | | 30 | | 135.0 | 137.60 | 26.0 | 60.3 | 20.70 | 80.3 | 25 | 53.0 | 7.3 | 35.0 |
| T 43658 | 5 | 16 | A | 80.0 | 88.90 | 25.0 | 50.0 | 56.10 | 60.0 | 20 | 45.0 | 5.0 | 21.1 |
| | | 32 | | 160.0 | 164.50 | 25.0 | 55.0 | 25.60 | 85.0 | 25 | 48.0 | 7.0 | 27.0 |
| T 43728 | 5 | 15 | B | 75.0 | 87.00 | 30.0 | 57.6 | 46.40 | 60.3 | 20 | - | - | 25.3 |
| | | 30 | | 150.0 | 152.90 | 30.0 | 62.5 | 22.50 | 80.3 | 25 | 56.0 | 6.5 | 35.0 |

Kuže ové súkolie 1:3

Priame ozubenie, uhol záberu 20°

Oce C 43

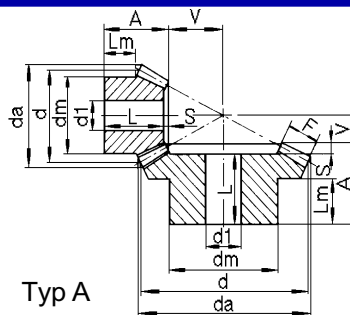

Typ A

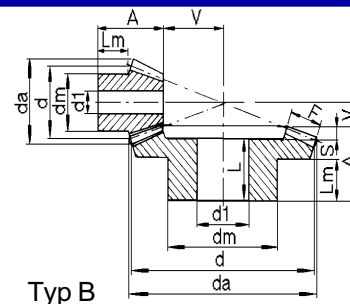

Typ B

Prevodový pomer 1:3

| Obj. číslo | Modul | zubov | Typ | d | da | F | A | V | dm | d1 | L | S | Lm |
|------------|-------|-------|-----|-------|--------|------|------|-------|-------|----|------|------|------|
| T 43729 | 1 | 15 | B | 15.0 | 17.70 | 7.1 | 16.6 | 15.40 | 13.3 | 4 | - | - | 9.3 |
| | | 45 | | 45.0 | 45.30 | 7.1 | 17.1 | 4.90 | 25.3 | 8 | 15.0 | 2.1 | 10.0 |
| T 43659 | 1.5 | 16 | A | 24.0 | 26.90 | 12.0 | 22.0 | 24.30 | 20.0 | 10 | 21.0 | 1.0 | 9.7 |
| | | 48 | | 72.0 | 72.90 | 12.0 | 22.0 | 7.20 | 42.0 | 15 | 19.0 | 3.0 | 12.0 |
| T 43730 | 1.5 | 15 | B | 22.5 | 26.50 | 10.5 | 22.6 | 23.40 | 19.3 | 8 | - | - | 11.7 |
| | | 45 | | 67.5 | 68.10 | 10.5 | 29.6 | 7.40 | 45.3 | 14 | 27.0 | 2.6 | 20.0 |
| T 43660 | 2 | 16 | A | 32.0 | 35.80 | 15.0 | 25.5 | 33.40 | 25.0 | 12 | 24.0 | 1.5 | 9.4 |
| | | 48 | | 96.0 | 97.30 | 15.0 | 26.0 | 9.90 | 50.0 | 15 | 22.0 | 4.0 | 13.0 |
| T 43731 | 2 | 15 | B | 30.0 | 35.40 | 14.0 | 28.9 | 31.10 | 25.3 | 8 | - | - | 14.2 |
| | | 45 | | 90.0 | 90.80 | 14.0 | 32.1 | 9.90 | 45.3 | 15 | 29.0 | 3.1 | 20.0 |
| T 43661 | 2.5 | 16 | A | 40.0 | 44.70 | 18.0 | 28.0 | 42.40 | 33.0 | 14 | 26.0 | 2.0 | 9.2 |
| | | 48 | | 120.0 | 121.60 | 18.0 | 32.0 | 12.60 | 60.0 | 20 | 27.0 | 5.0 | 16.0 |
| T 43732 | 2.5 | 15 | B | 37.5 | 44.20 | 18.0 | 34.6 | 38.40 | 32.3 | 12 | - | - | 15.9 |
| | | 45 | | 112.5 | 113.40 | 18.0 | 39.7 | 12.30 | 60.3 | 20 | 36.0 | 3.7 | 25.0 |
| T 43662 | 3 | 16 | A | 48.0 | 53.70 | 18.0 | 30.0 | 54.20 | 42.0 | 15 | 28.0 | 2.0 | 11.2 |
| | | 48 | | 144.0 | 145.90 | 18.0 | 38.0 | 16.10 | 65.0 | 20 | 32.0 | 6.0 | 19.0 |
| T 43733 | 3 | 15 | B | 45.0 | 53.00 | 21.0 | 41.3 | 46.70 | 40.3 | 15 | - | - | 19.7 |
| | | 45 | | 135.0 | 136.10 | 21.0 | 47.2 | 14.80 | 60.3 | 20 | 42.5 | 4.7 | 30.0 |
| T 43663 | 3.5 | 16 | A | 56.0 | 62.60 | 22.0 | 36.5 | 62.30 | 48.0 | 15 | 34.0 | 2.5 | 13.4 |
| | | 48 | | 168.0 | 170.20 | 22.0 | 44.0 | 18.50 | 75.0 | 20 | 37.0 | 7.0 | 23.0 |
| T 43734 | 3.5 | 15 | B | 52.5 | 61.90 | 23.5 | 49.6 | 55.40 | 45.3 | 15 | - | - | 25.1 |
| | | 45 | | 157.5 | 158.80 | 23.5 | 54.4 | 17.60 | 80.3 | 20 | 49.0 | 5.4 | 35.0 |
| T 43664 | 4 | 16 | A | 64.0 | 71.60 | 25.0 | 42.0 | 71.30 | 55.0 | 20 | 39.0 | 3.0 | 15.7 |
| | | 48 | | 192.0 | 194.50 | 25.0 | 50.0 | 21.20 | 85.0 | 22 | 42.0 | 8.0 | 27.0 |
| T 43735 | 4 | 15 | B | 60.0 | 70.70 | 27.5 | 54.3 | 62.70 | 50.3 | 20 | - | - | 25.4 |
| | | 45 | | 180.0 | 181.50 | 27.5 | 57.0 | 20.00 | 80.3 | 22 | 51.0 | 6.0 | 35.0 |
| T 43665 | 4.5 | 16 | A | 72.0 | 80.60 | 28.0 | 53.0 | 80.40 | 60.0 | 20 | 50.0 | 3.0 | 23.4 |
| | | 48 | | 216.0 | 218.80 | 28.0 | 58.0 | 23.90 | 90.0 | 25 | 49.0 | 9.0 | 27.0 |
| T 43736 | 4.5 | 15 | B | 67.5 | 79.50 | 28.5 | 55.2 | 72.80 | 55.3 | 20 | - | - | 24.8 |
| | | 45 | | 202.5 | 204.20 | 28.5 | 63.9 | 23.10 | 90.3 | 25 | 57.0 | 6.9 | 40.0 |
| T 43666 | 5 | 16 | A | 80.0 | 89.50 | 35.0 | 60.0 | 85.70 | 60.0 | 20 | 57.0 | 3.0 | 22.5 |
| | | 48 | | 240.0 | 243.10 | 35.0 | 65.0 | 25.50 | 100.0 | 28 | 55.0 | 10.0 | 35.0 |
| T 43737 | 5 | 15 | B | 75.0 | 88.40 | 33.0 | 65.3 | 79.70 | 60.3 | 20 | - | - | 30.0 |
| | | 45 | | 225.0 | 226.90 | 33.0 | 66.7 | 25.30 | 90.3 | 28 | 59.0 | 7.7 | 40.0 |

Kuže ové súkolie 1:4

Priame ozubenie, uhol záberu 20°

Oce C 43

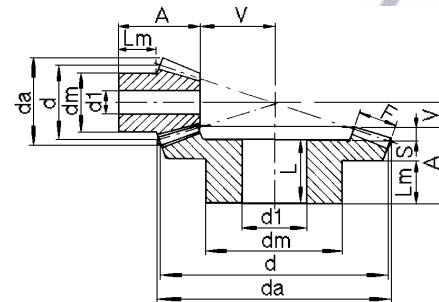
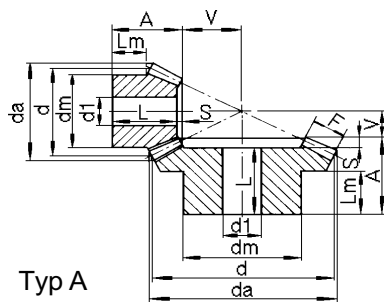

Prevodový pomer 1:4

| Obj. číslo | Modul | zubov | Typ | d | da | F | A | V | dm | d1 | L | S | Lm |
|------------|-------|-------|-----|-------|--------|------|------|--------|-------|----|------|------|------|
| T 43738 | 1 | 15 | B | 15.0 | 17.80 | 9.3 | 17.2 | 20.80 | 13.3 | 4 | - | - | 7.7 |
| | | 60 | | 60.0 | 60.30 | 9.3 | 17.1 | 4.90 | 30.3 | 8 | 15.0 | 2.1 | 10.0 |
| T 43667 | 1.5 | 16 | A | 24.0 | 26.90 | 12.0 | 25.0 | 36.10 | 18.0 | 10 | 24.0 | 1.0 | 12.2 |
| | | 64 | | 96.0 | 96.70 | 12.0 | 25.0 | 8.00 | 60.0 | 15 | 22.0 | 3.0 | 13.0 |
| T 43739 | 1.5 | 15 | B | 22.5 | 26.70 | 11.0 | 23.0 | 34.00 | 20.3 | 8 | - | - | 11.7 |
| | | 60 | | 90.0 | 90.40 | 11.0 | 34.0 | 8.00 | 50.3 | 15 | 31.0 | 3.0 | 25.0 |
| T 43668 | 2 | 16 | A | 32.0 | 35.90 | 15.0 | 24.0 | 49.10 | 25.0 | 12 | 23.0 | 1.0 | 8.5 |
| | | 64 | | 128.0 | 129.00 | 15.0 | 28.0 | 10.90 | 70.0 | 20 | 24.0 | 4.0 | 14.0 |
| T 43740 | 2 | 15 | B | 30.0 | 35.60 | 16.0 | 31.0 | 44.00 | 25.3 | 8 | - | - | 14.4 |
| | | 60 | | 120.0 | 120.60 | 16.0 | 37.6 | 10.40 | 60.3 | 16 | 34.0 | 3.6 | 25.0 |
| T 43669 | 2.5 | 16 | A | 40.0 | 44.90 | 18.0 | 30.5 | 62.10 | 34.0 | 15 | 29.0 | 1.5 | 11.7 |
| | | 64 | | 160.0 | 161.20 | 18.0 | 35.0 | 13.80 | 80.0 | 20 | 30.0 | 5.0 | 16.0 |
| T 43741 | 2.5 | 15 | B | 37.5 | 44.50 | 19.0 | 38.1 | 55.90 | 32.3 | 14 | - | - | 18.4 |
| | | 60 | | 150.0 | 150.70 | 19.0 | 44.8 | 13.20 | 60.3 | 20 | 40.0 | 4.8 | 30.0 |
| T 43670 | 3 | 16 | A | 48.0 | 53.80 | 20.0 | 32.0 | 76.00 | 40.0 | 15 | 30.0 | 2.0 | 11.1 |
| | | 64 | | 192.0 | 193.40 | 20.0 | 42.0 | 16.80 | 90.0 | 20 | 36.0 | 6.0 | 22.0 |
| T 43742 | 3 | 15 | B | 45.0 | 53.30 | 23.0 | 48.1 | 66.90 | 40.3 | 15 | - | - | 24.5 |
| | | 60 | | 180.0 | 180.80 | 23.0 | 53.2 | 15.80 | 80.3 | 20 | 48.0 | 5.2 | 35.0 |
| T 43671 | 3.5 | 16 | A | 56.0 | 62.80 | 25.0 | 40.0 | 87.10 | 45.0 | 15 | 38.0 | 2.0 | 14.0 |
| | | 64 | | 224.0 | 225.70 | 25.0 | 50.0 | 19.30 | 100.0 | 25 | 43.0 | 7.0 | 22.0 |
| T 43743 | 3.5 | 15 | B | 52.5 | 62.20 | 26.0 | 52.1 | 78.90 | 45.3 | 15 | - | - | 25.1 |
| | | 60 | | 210.0 | 211.00 | 26.0 | 60.4 | 18.60 | 90.3 | 25 | 54.0 | 6.4 | 40.0 |
| T 43672 | 4 | 16 | A | 64.0 | 71.70 | 30.0 | 50.0 | 98.20 | 50.0 | 20 | 48.0 | 2.0 | 18.5 |
| | | 64 | | 256.0 | 257.90 | 30.0 | 60.0 | 21.80 | 110.0 | 28 | 52.0 | 8.0 | 30.0 |
| T 43744 | 4 | 15 | B | 60.0 | 71.10 | 30.0 | 55.1 | 89.90 | 50.3 | 20 | - | - | 23.8 |
| | | 60 | | 240.0 | 241.10 | 30.0 | 60.8 | 21.20 | 90.3 | 28 | 53.0 | 7.8 | 40.0 |
| T 43673 | 4.5 | 16 | A | 72.0 | 80.70 | 32.0 | 55.0 | 112.10 | 60.0 | 20 | 53.0 | 2.0 | 21.6 |
| | | 64 | | 288.0 | 290.10 | 32.0 | 65.0 | 24.80 | 120.0 | 30 | 57.0 | 8.0 | 35.0 |
| T 43745 | 4.5 | 15 | B | 67.5 | 79.90 | 34.0 | 59.1 | 100.90 | 60.3 | 20 | - | - | 24.1 |
| | | 60 | | 270.0 | 271.20 | 34.0 | 68.2 | 23.80 | 100.3 | 30 | 61.0 | 7.2 | 40.0 |
| T 43674 | 5 | 16 | A | 80.0 | 89.70 | 35.0 | 60.0 | 125.10 | 65.0 | 20 | 58.0 | 2.0 | 23.2 |
| | | 64 | | 320.0 | 322.40 | 35.0 | 70.0 | 27.70 | 120.0 | 30 | 61.0 | 11.0 | 42.0 |
| T 43746 | 5 | 15 | B | 75.0 | 88.80 | 38.0 | 68.1 | 111.90 | 70.3 | 20 | - | - | 29.4 |
| | | 60 | | 300.0 | 310.30 | 38.0 | 73.5 | 26.50 | 110.3 | 30 | 66.0 | 7.5 | 40.0 |

Kuže ové súkolie 1:1

Špirálové ozubenie, uhol záberu 20°

Oce C 43

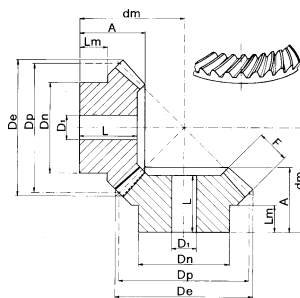

Prevodový pomer 1:1

| Obj. číslo | Modul | zubov | De | Dp | A | F | Dn | D1 | dm | L | Lm |
|------------|-------|-------|-------|-------|------|----|-----|----|-----|------|------|
| F 03268 | 2 | 16 | 34.6 | 32 | 19.9 | 9 | 25 | 10 | 29 | 16.9 | 9.5 |
| F 03269 | | 20 | 42.6 | 40 | 24.9 | 12 | 32 | 10 | 36 | 21.7 | 12 |
| F 03270 | | 25 | 52.6 | 50 | 27.4 | 14 | 40 | 12 | 42 | 24.8 | 12 |
| F 03271 | | 30 | 62.6 | 60 | 29.9 | 16 | 50 | 12 | 48 | 26.9 | 13 |
| F 03272 | 2.5 | 16 | 43.2 | 40 | 24.8 | 10 | 32 | 12 | 37 | 21.8 | 13 |
| F 03273 | | 20 | 53.3 | 50 | 30.2 | 12 | 40 | 12 | 46 | 26.7 | 16 |
| F 03274 | | 25 | 65.8 | 62.5 | 33.2 | 15 | 50 | 15 | 53 | 29.9 | 16 |
| F 03275 | | 30 | 78.3 | 75 | 35 | 18 | 55 | 15 | 59 | 31.8 | 16 |
| F 03276 | 3 | 16 | 51.9 | 48 | 29.4 | 12 | 40 | 15 | 44 | 25.8 | 16 |
| F 03277 | | 20 | 63.9 | 60 | 34.5 | 18 | 45 | 15 | 51 | 30.7 | 13.5 |
| F 03278 | | 25 | 78.9 | 75 | 37.5 | 20 | 55 | 15 | 60 | 33.7 | 16 |
| F 03279 | | 30 | 93.9 | 90 | 39.5 | 22 | 60 | 20 | 68 | 35.8 | 19 |
| F 03280 | 3.5 | 16 | 60.2 | 56 | 34.1 | 14 | 45 | 15 | 51 | 29.5 | 17.5 |
| F 03281 | | 20 | 74.2 | 70 | 35.9 | 15 | 55 | 15 | 59 | 31.2 | 19 |
| F 03282 | | 25 | 91.7 | 87.5 | 40.5 | 21 | 65 | 20 | 68 | 36.5 | 18 |
| F 03283 | | 30 | 109.2 | 105 | 41.9 | 24 | 70 | 20 | 76 | 37 | 17 |
| F 03284 | 4 | 16 | 68.8 | 64 | 36 | 15 | 50 | 15 | 56 | 30.8 | 17 |
| F 03285 | | 20 | 84.8 | 80 | 37.5 | 17 | 60 | 18 | 64 | 32.5 | 18 |
| F 03286 | | 25 | 104.8 | 100 | 40.4 | 21 | 70 | 20 | 74 | 35.2 | 18 |
| F 03287 | | 30 | 124.8 | 120 | 43.2 | 25 | 80 | 25 | 84 | 38.1 | 16 |
| F 03288 | 4.5 | 16 | 77.4 | 72 | 39.3 | 15 | 55 | 18 | 63 | 33.5 | 18.5 |
| F 03289 | | 20 | 95.4 | 90 | 42.8 | 20 | 65 | 20 | 72 | 36.5 | 18 |
| F 03290 | | 25 | 117.9 | 112.5 | 45 | 25 | 75 | 20 | 82 | 39 | 18 |
| F 03291 | | 30 | 140.4 | 135 | 48 | 28 | 90 | 25 | 94 | 42 | 17 |
| F 03292 | 5 | 16 | 86 | 80 | 41.9 | 17 | 60 | 20 | 68 | 35.5 | 18 |
| F 03293 | | 20 | 106 | 100 | 44.7 | 21 | 70 | 20 | 78 | 37.7 | 18.5 |
| F 03294 | | 25 | 131 | 125 | 47.8 | 26 | 90 | 20 | 90 | 41.8 | 18.5 |
| F 03295 | | 30 | 156 | 150 | 52.5 | 32 | 110 | 30 | 103 | 45.7 | 18 |

Kuže ové súkolie 1:2, 1:3, 1:4

Špirálové ozubenie, uhol záberu 20°

Oce C 43

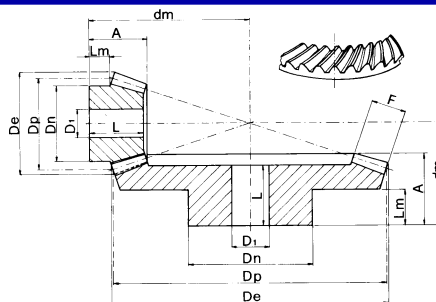

Prevodový pomer 1:2

| Obj. číslo | Modul | zubov | De | Dp | A | F | Dn | D1 | dm | L | Lm |
|------------|-------|-------|-------|-----|------|----|----|----|-----|------|------|
| F 03296 | 2 | 16 | 36.6 | 32 | 22.5 | 10 | 27 | 10 | 45 | 21 | 11.7 |
| | | 32 | 65.0 | 64 | 24.1 | 10 | 40 | 12 | 35 | 21.5 | 10 |
| F 03297 | 2.5 | 16 | 45.7 | 40 | 27.5 | 12 | 34 | 12 | 56 | 25.1 | 14.5 |
| | | 32 | 81.3 | 80 | 29.2 | 12 | 50 | 15 | 43 | 25.9 | 15 |
| F 03298 | 3 | 16 | 54.1 | 48 | 28.4 | 15 | 40 | 15 | 62 | 25.2 | 12 |
| | | 32 | 97.5 | 96 | 34.6 | 15 | 60 | 15 | 51 | 29.8 | 15 |
| F 03299 | 3.5 | 16 | 63.2 | 56 | 33.3 | 18 | 48 | 15 | 72 | 30.8 | 14 |
| | | 32 | 113.8 | 112 | 39.1 | 18 | 70 | 20 | 58 | 34.1 | 19 |
| F 03300 | 4 | 16 | 72.2 | 64 | 36.2 | 20 | 50 | 20 | 81 | 32.2 | 13.5 |
| | | 32 | 130 | 128 | 44.2 | 20 | 80 | 20 | 66 | 38.7 | 23 |
| F 03301 | 4.5 | 16 | 81.2 | 72 | 40.2 | 22 | 60 | 20 | 91 | 35.3 | 16 |
| | | 32 | 146.2 | 144 | 49.2 | 22 | 80 | 25 | 74 | 42.4 | 24 |
| F 03302 | 5 | 16 | 90.2 | 80 | 50 | 25 | 60 | 20 | 106 | 45.3 | 21 |
| | | 32 | 162.5 | 160 | 53.7 | 25 | 85 | 25 | 81 | 46.8 | 27 |

Prevodový pomer 1:3

| Obj. číslo | Modul | zubov | De | Dp | A | F | Dn | D1 | dm | L | Lm |
|------------|-------|-------|-------|-----|------|----|-----|----|-----|------|------|
| F 03303 | 2 | 16 | 37.1 | 32 | 25.6 | 15 | 25 | 12 | 59 | 24 | 9.7 |
| | | 48 | 96.6 | 96 | 25.2 | 15 | 50 | 15 | 36 | 21.4 | 13 |
| F 03304 | 2.5 | 16 | 46.4 | 40 | 27.7 | 18 | 33 | 14 | 70 | 26.2 | 8.9 |
| | | 48 | 120.8 | 120 | 31.4 | 18 | 60 | 20 | 45 | 26.3 | 16 |
| F 03305 | 3 | 16 | 54.8 | 48 | 29.8 | 18 | 42 | 15 | 84 | 28.1 | 11 |
| | | 48 | 145 | 144 | 36.6 | 18 | 65 | 20 | 54 | 31.1 | 19 |
| F 03306 | 3.5 | 16 | 64 | 56 | 36.8 | 22 | 48 | 15 | 99 | 33.9 | 13.6 |
| | | 48 | 169.1 | 168 | 43.1 | 22 | 75 | 20 | 63 | 36 | 23 |
| F 03307 | 4 | 16 | 73.1 | 64 | 41.7 | 25 | 55 | 20 | 113 | 39.2 | 15.5 |
| | | 48 | 193.3 | 192 | 49.2 | 25 | 85 | 22 | 72 | 40.9 | 27 |
| F 03308 | 4.5 | 16 | 82.2 | 72 | 53.7 | 28 | 60 | 20 | 134 | 50.2 | 24 |
| | | 48 | 217.4 | 216 | 56.2 | 28 | 90 | 25 | 82 | 47.6 | 27 |
| F 03309 | 5 | 16 | 91.4 | 80 | 60.4 | 35 | 60 | 20 | 146 | 57.2 | 22.7 |
| | | 48 | 241.6 | 240 | 63.6 | 35 | 100 | 28 | 91 | 53.6 | 35 |

Prevodový pomer 1:4

| Obj. číslo | Modul | zubov | De | Dp | A | F | Dn | D1 | dm | L | Lm |
|------------|-------|-------|-------|-----|------|----|----|----|-----|------|------|
| F 03310 | 2 | 16 | 37.3 | 32 | 24 | 15 | 25 | 12 | 73 | 23.1 | 8.2 |
| | | 64 | 128.5 | 128 | 27.2 | 15 | 70 | 20 | 39 | 23.3 | 14 |
| F 03311 | 2.5 | 16 | 46.7 | 40 | 31 | 18 | 34 | 15 | 93 | 29.1 | 12.2 |
| | | 64 | 160.6 | 160 | 34.2 | 18 | 80 | 20 | 49 | 29.2 | 16 |
| F 03312 | 3 | 16 | 55.1 | 48 | 32.1 | 20 | 40 | 15 | 108 | 30.2 | 11 |
| | | 64 | 192.7 | 192 | 40.9 | 20 | 90 | 20 | 59 | 35.1 | 22 |